

## DLV72-BHP

THROUGH BEAM SENSOR  
with integrated amplifier

- ⤷ high resolution
- ⤷ high power reserve
- ⤷ flexible cable
- ⤷ robust design

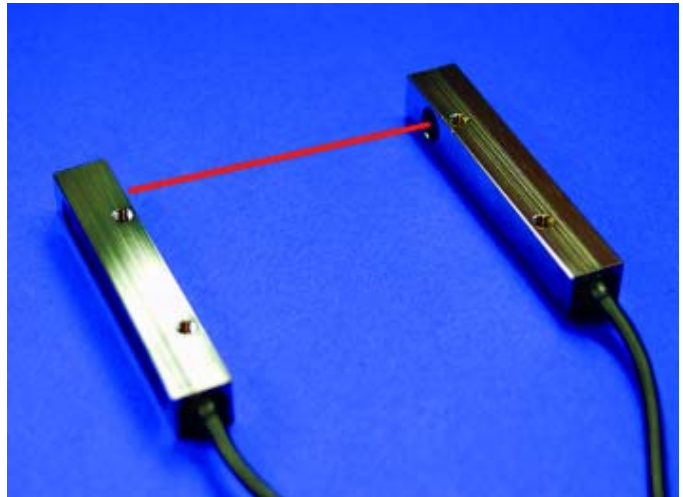

### GENERAL TECHNICAL DATA

light type	Infrared 880nm
temperature range	-10°C to +55°C
protection class	IP65
connection type	3m PUR cable

TYPE	DLV72-BHP	DLV72-BDP
functional principle	pulsed light-on	pulsed dark-on
frequency response	500 Hz	
function indicator	LED infrared	
operating voltage	10...30 VDC reverse polarity protection	
sensing distance	3000mm	
output current	PNP 100 mA short-circuit proof	

**DIMENSION**

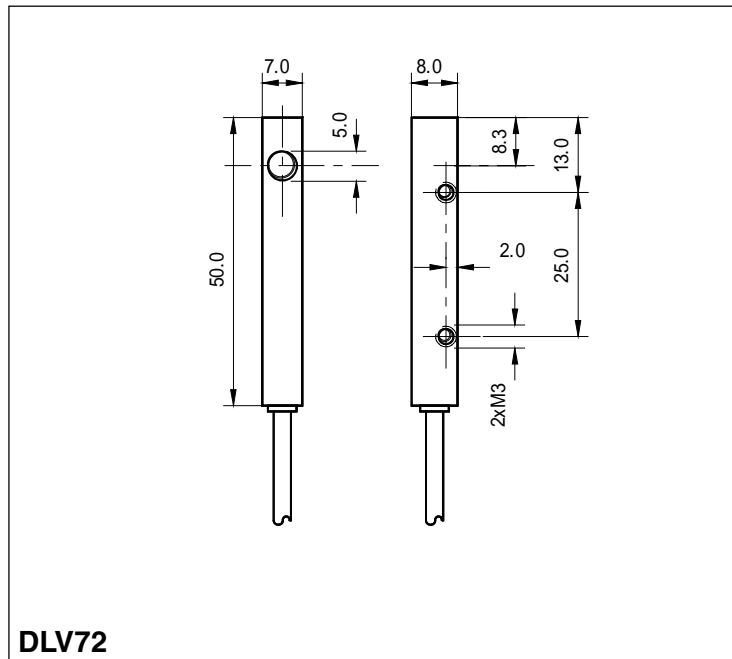

**ORDER EXAMPLE**

<b>DLV72-BHP</b>	infrared	pulsed	light-on	PNP-output
<b>DLV72-BDP</b>	infrared	pulsed	dark-on	PNP-output