

DLH30RM • DLH50RM

MICRO THROUGH BEAM SENSOR
with separate amplifier

- ⊃ ideal for direct mounting in metal sheets
- ⊃ reduced mounting space due to 90° cable outlet
- ⊃ robust design - glass protected optics
- ⊃ hexagonal body shape
- ⊃ stainless steel



micro SPOT®
micro SPOT is a new and powerful LED technology for miniaturized opto sensors

GENERAL TECHNICAL DATA

| | |
|--------------------------|--------------------------|
| light type | microSPOT 645nm |
| connection type | PUR-cable with connector |
| temperature range | -10°C to +55°C |
| protection class | IP67 |

SMALLEST OBJECT and SENSING DISTANCE

| | | |
|----------------|---|---------|
| DLH30RM | sensing distance | 500 mm |
| | smallest object (Ø copper wire)* | 0,05 mm |
| DLH50RM | sensing distance | 2000 mm |
| | smallest object (Ø copper wire)* | 0,3 mm |

*copper wire of infinite length

| | |
|--|--|
| <ul style="list-style-type: none"> • M3 x 0,5mm x 7mm • Stainless steel • microSPOT 645nm | <p>DLH30RM</p> <p>Actual size</p> |
|--|--|

| | |
|--|--|
| <ul style="list-style-type: none"> • M5 x 0,5mm x 8mm • Stainless steel • microSPOT 645nm | <p>DLH50RM</p> <p>Actual size</p> |
|--|--|

DIMENSIONS

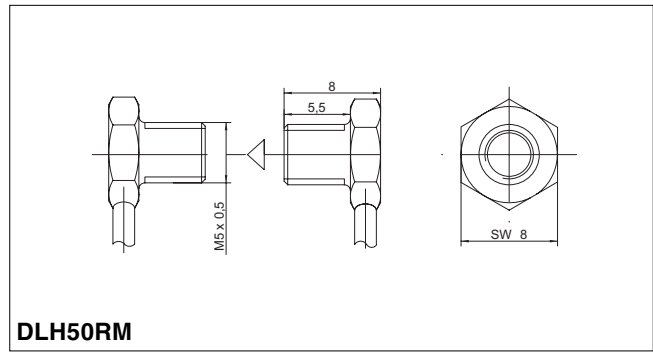
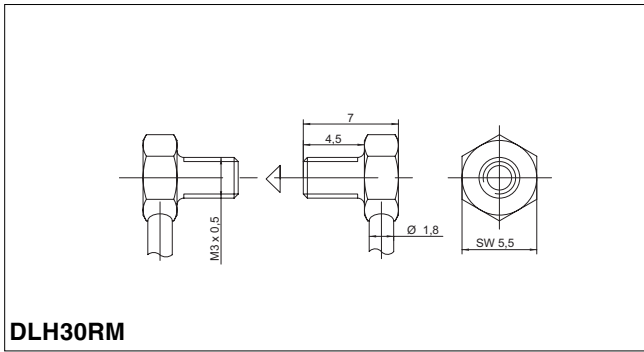

PART DESIGNATION

DLH30RM - - :
DLH50RM - - :

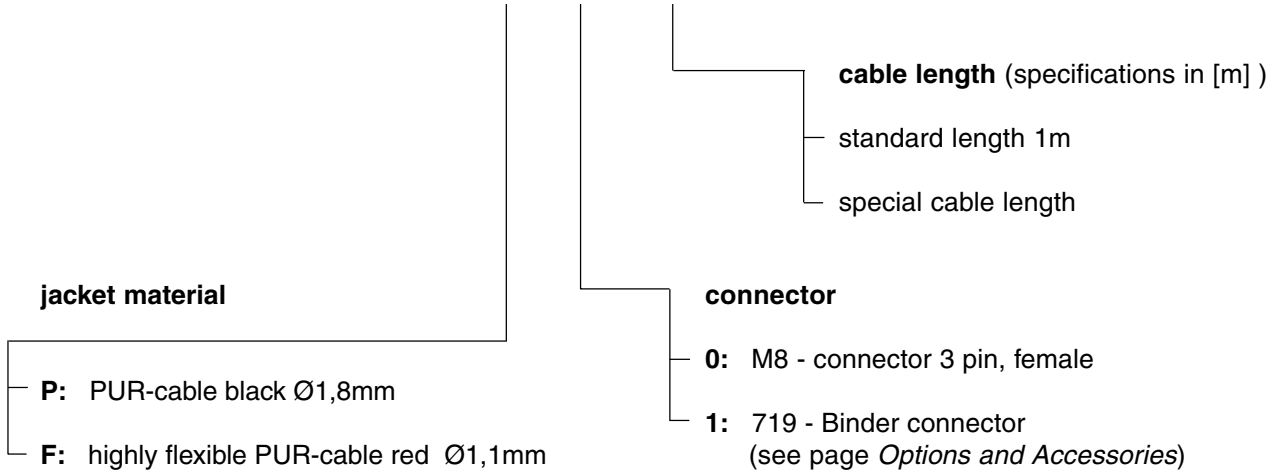

ORDER EXAMPLE:

DLH30RM-P-0:1m = DLH30RM - PUR-cable black - M8, 3 pin female: (cable length 1m x 2)

Please remember, for correct operation, a separate amplifier is required.