

## DLV365RM

MICRO THROUGH BEAM SENSOR  
with separate amplifier

- ▶ very high resolution
- ▶ very high signal reserve
- ▶ low beam angle (small beam spot)
- ▶ homogenous lightspot
- ▶ excellent optical fibre replacement  
(highly flexible sensor-cable with copper wire)

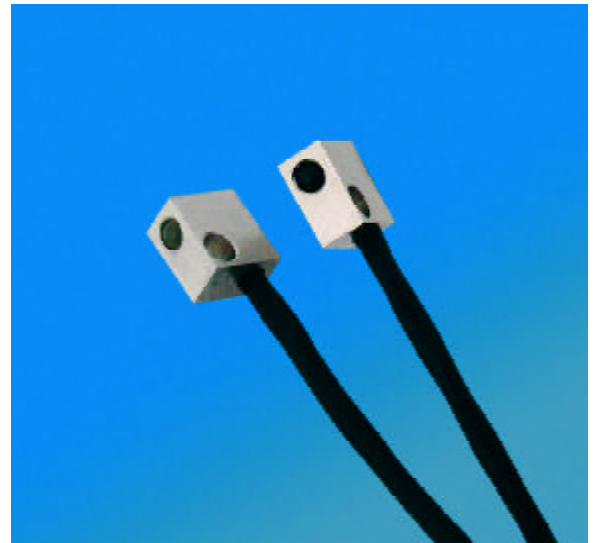

**micro SPOT**<sup>®</sup>  
MICRO-SPOT is a new and powerful LED technology for miniaturized opto sensors.

DLV365RM

### TECHNICAL SENSOR DATA

<b>light type</b>	red 645nm
<b>connection type</b>	2 x 1m PUR-cable
<b>temperature range</b>	-10°C...+55°C
<b>protection class</b>	IP 65

<ul style="list-style-type: none"> <li>● 3 mm x 5,5 mm x 5 mm</li> <li>● Nickel-plated brass</li> </ul>	<p><b>DLV365RM</b></p> <p><small>Actual size</small></p>
---	--

### SMALLEST OBJECT and SENSING DISTANCE

<b>sensing distance</b>	max. 500 mm
<b>smallest object*</b>	Ø 0,05 mm

\*copper wire of infinite length

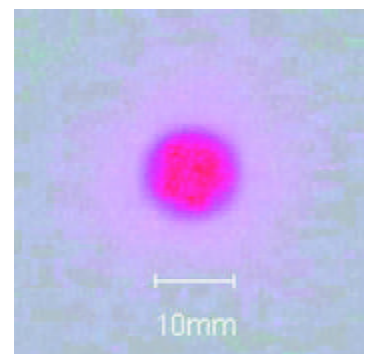

beam spot at 100mm distance

**DIMENSIONS**

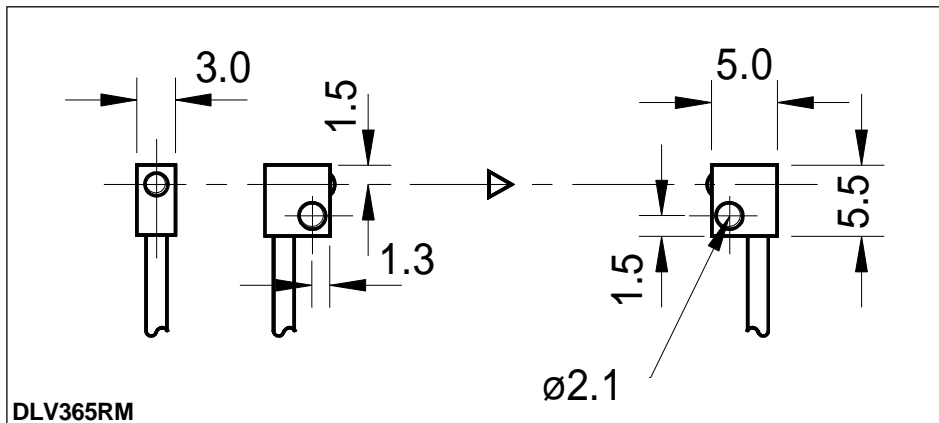

**PART DESIGNATION**

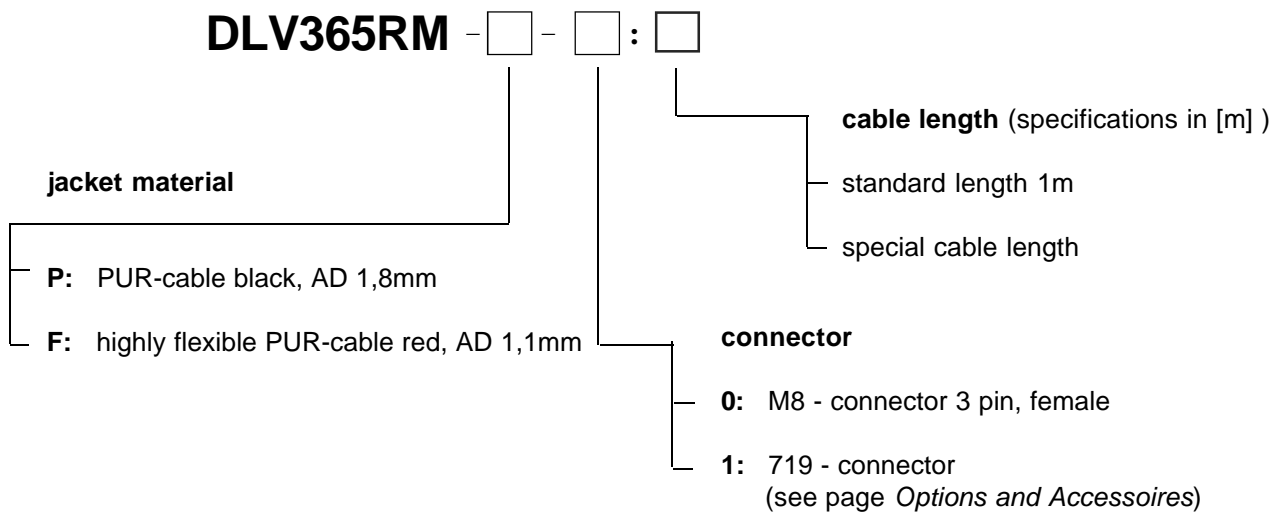

**ORDER EXAMPLE:**

DLV365RM-P-0:1m = DLV365RM Red light - PUR-cable black - M8, 3 pin female: (cable length 2 x 1m)

**Please remember, for correct operation, a separate amplifier is required.**