

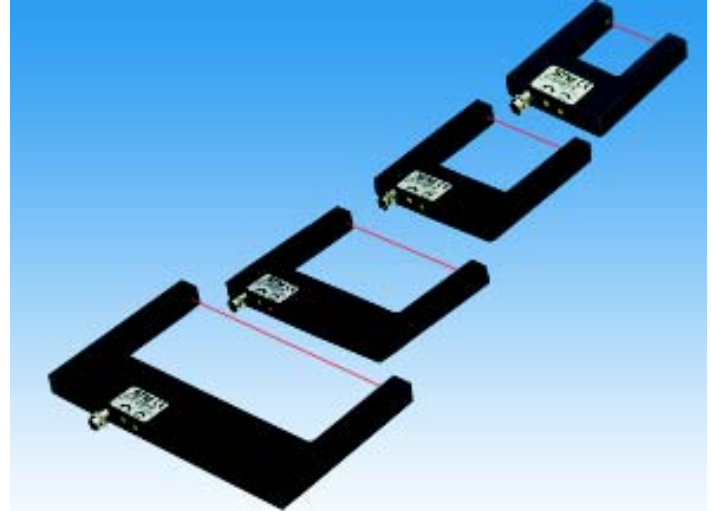

GLSK

STANDARD LASER FORK SENSOR
with integrated amplifier

- pre-packaged through beam sensor, ready to use, easy to mount (perfect for all standard through beam applications)
- precise laser beam guarantees high resolution and reproducibility over the full fork width
- integrated amplifier
- 4 different standard sizes



GENERAL TECHNICAL DATA

operating voltage	10...30 VDC, reverse polarity protected
current consumption	≤ 35mA
output	PNP or NPN
output current	max. 200mA, short circuit proof
function indicator	LED, red (on the connector)
frequency response	3kHz
functional principle	modulated
switching function	light-on or dark-on selectable
light type	laser red 650nm
sensitivity adjustment	potentiometer, 270°
housing material	aluminium, black anodized
operating temperature	-10°C.. +60°C
protection class	IP65
connector	M8, 3pin*

*supply cable to be ordered separately

fork width (mm)	resolution	reproducibility
30	0,06mm	15µm
50	0,1mm	20µm
80	0,2mm	30µm
120	0,3mm	50µm

LASER RADIATION-DO NOT STARE INTO BEAM

EN 60825-1:2001
P < 1mW, λ=630...670nm
Pulsed - mode operation
Class 2 laser product

DIMENSIONS

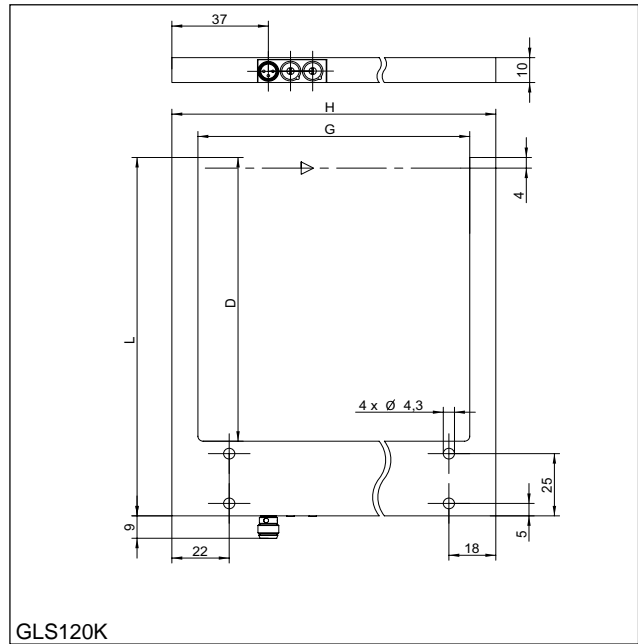
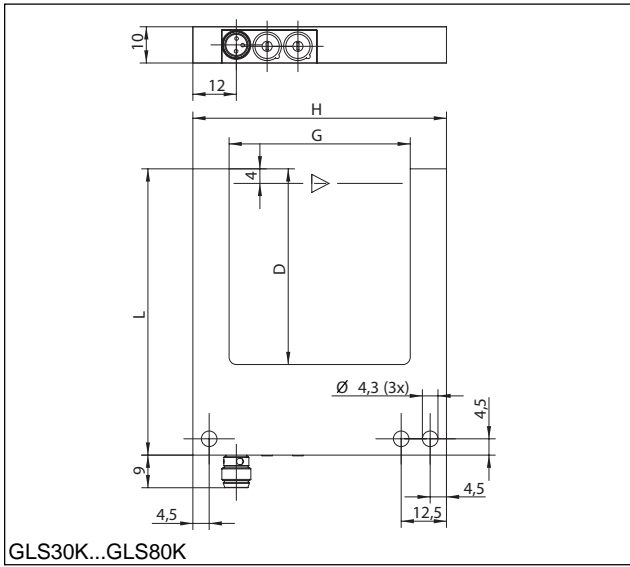

Type:	G:	D:	L:	H:
GLS30K-BP / GLS30K-BN	30mm	17mm	54mm	25mm
GLS50K-BP / GLS50K-BN	50mm	17mm	54mm	30mm
GLS80K-BP / GLS80K-BN	80mm	24mm	58mm	40mm
GLS120K-BP / GLS120K-BN	120mm	34mm	68mm	50mm

CONNECTION DIAGRAM

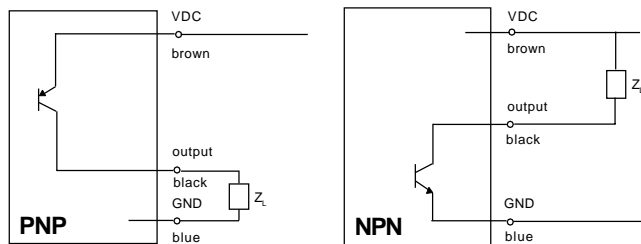

PART DESIGNATION

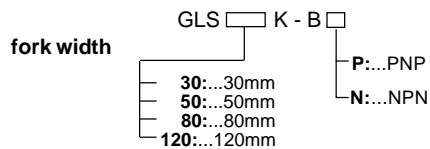

ORDER EXAMPLE:

GLS50K-BP = fork width 50 - laser light - PNP

Do not forget to order the appropriate power supply cable!